

MYERS - LAWRENCE LAKE BENCHMARKS

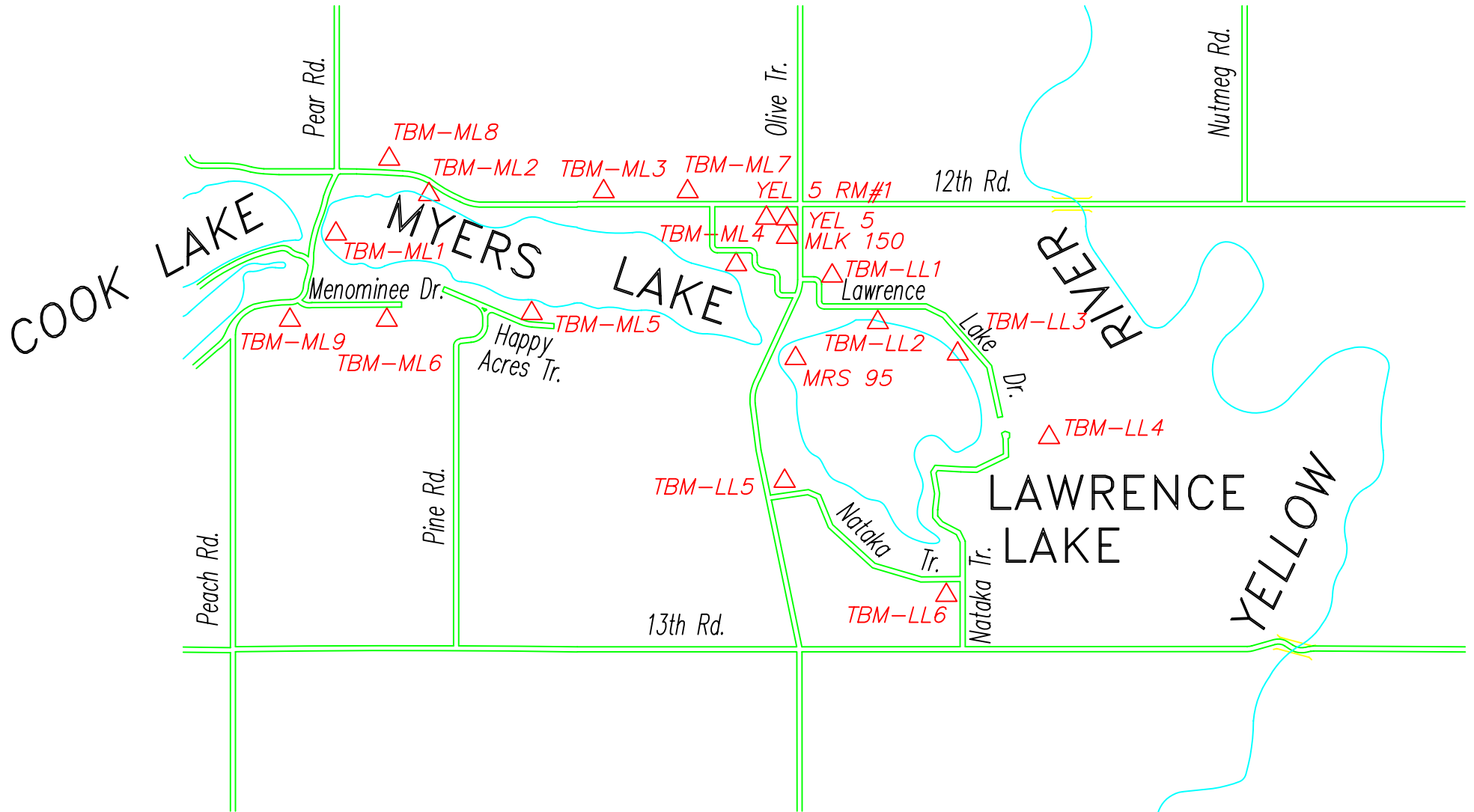

TBM-ML1

RAILROAD SPIKE IN WEST SIDE OF UTILITY POLE #12164, APPROXIMATELY 0.1 MILE SOUTH ALONG PEAR ROAD FROM INTERSECTION WITH 12TH ROAD , APPROXIMATELY 18 FEET EAST OF PEAR ROAD CENTERLINE.

ELEV.: 781.26 NGVD 29

TBM-ML2

RAILROAD SPIKE IN NORTHEAST SIDE OF UTILITY POLE #23/3R, APPROXIMATELY 0.2 MILE EAST ALONG 12TH ROAD FROM INTERSECTION WITH PEAR ROAD , APPROXIMATELY 21 FEET SOUTH OF 12TH ROAD CENTERLINE.

ELEV.: 810.13 NGVD 29

TBM-ML3

RAILROAD SPIKE IN SOUTH SIDE OF UTILITY POLE #14847N1, APPROXIMATELY 0.3 MILE WEST ALONG 12TH ROAD FROM INTERSECTION WITH OLIVE TRAIL, 21 FEET NORTH OF 12TH ROAD CENTERLINE.

ELEV.: 809.48 NGVD 29

TBM-ML4

RAILROAD SPIKE IN NORTH SIDE OF UTILITY POLE #14632S1, APPROXIMATELY 0.1 MILE SOUTH AND EAST ALONG 12B ROAD FROM INTERSECTION WITH 12TH ROAD, APPROXIMATELY 150 FEET EAST OF A CURVE TO THE EAST, 20 FEET SOUTH OF 12B ROAD CENTERLINE.

ELEV.: 805.14 NGVD 29

TBM-ML5

RAILROAD SPIKE IN SOUTH SIDE OF UTILITY POLE #15102, APPROXIMATELY 0.8 MILE NORTH AND EAST ALONG PINE ROAD FROM INTERSECTION WITH 13TH ROAD, APPROXIMATELY 280 FEET EAST ALONG HAPPY ACRES TRAIL FROM CUL-DE-SAC, 18 FEET NORTH OF HAPPY ACRES TRAIL CENTERLINE.

ELEV.: 787.84 NGVD 29

TBM-ML6

RAILROAD SPIKE IN NORTH SIDE OF UTILITY POLE, APPROXIMATELY 0.2 MILE EAST ALONG MENOMINEE DRIVE FROM INTERSECTION WITH PEAR ROAD, ACROSS ROAD FROM SOUTHWEST CORNER OF 15378 MENOMINEE DRIVE, 18 FEET SOUTH OF MENOMINEE DRIVE CENTERLINE.

ELEV.: 809.09 NGVD 29

TBM-ML7

TOP OF THE SOUTHWEST CORNER OF RAILROAD RAIL POST, 0.25 MILE WEST ALONG 12TH ROAD FROM INTERSECTION WITH OLIVE TRAIL, 4.6' ABOVE GRADE, 18 FEET NORTH OF 12TH ROAD CENTERLINE.

ELEV.: 815.51 NGVD 29

TBM-ML8

A CHISELED TRIANGLE IN THE NORTHEAST CORNER OF CONCRETE HEADWALL OF 18 INCH CULVERT, APPROXIMATELY 0.1 MILE EAST ALONG 12TH ROAD FROM INTERSECTION WITH PEAR ROAD, ABOUT LEVEL WITH THE ROAD, 14 FEET NORTH OF 12TH ROAD CENTERLINE.

ELEV.: 807.62 NGVD 29

TBM-ML9

TOP OF THE NORTHWEST CORNER OF RAILROAD RAIL POST, APPROXIMATELY 125 FEET WEST ALONG PEAR ROAD FROM INTERSECTION WITH MENOMINEE DRIVE, 3.9' ABOVE GRADE, 18 FEET SOUTH OF PEAR ROAD CENTERLINE.

ELEV.: 808.61 NGVD 29

IDNR BM MRS 95 1978

DNR BRASS TABLET STAMPED "MRS 95 1978" SET IN TOP OF THE SOUTHEAST END OF THE SOUTHWEST BRIDGE ABUTMENT, AT THE OLIVE TRAIL CONCRETE BRIDGE OVER THE OUTLET CHANNEL FOR LAWRENCE LAKE, 15.5 FEET SOUTHEAST FROM THE CENTERLINE OF THE ROAD, 1.8 FEET BELOW THE ROADWAY, 0.8 FEET SOUTHWEST FROM THE NORTHEAST FACE OF THE ABUTMENT.

ELEV.: 773.042 NGVD 29

ELEV.: 772.616 NAVD 88

IDNR TBM MLK 150 1978

RAILROAD SPIKE DRIVEN THRU AN ALUMINUM TAG STAMPED "IDNR TBM MLK 150 1978", IN THE EAST SIDE OF UTILITY POLE IN THE SOUTHWEST QUARTER OF THE INTERSECTION OF 12TH ROAD AND OLIVE TRAIL, 54 FEET SOUTH OF 12TH ROAD CENTERLINE, 20' WEST OF OLIVE TRAIL CENTERLINE.

ELEV.: 805.325 NGVD 29

ELEV.: 804.896 NAVD 88

IDNR BM YEL 5

DNR BRASS TABLET STAMPED "YEL 5" SET IN TOP OF A CONCRETE POST IN THE SOUTHWEST QUARTER OF THE INTERSECTION OF 12TH ROAD AND OLIVE TRAIL, 61.4 FEET WEST OF OLIVE TRAIL CENTERLINE, 16.7 FEET SOUTH OF 12TH ROAD CENTERLINE.

ELEV.: 805.386 NGVD 29

ELEV.: 804.914 NAVD 88

IDNR BM YEL 5 RM #1

DNR BRASS TABLET STAMPED "YEL 5 RM #1" SET IN TOP OF A CONCRETE POST IN THE SOUTHWEST QUARTER OF THE INTERSECTION OF 12TH ROAD AND OLIVE TRAIL, 119.6 FEET WEST OF OLIVE TRAIL CENTERLINE, 13.7 FEET SOUTH OF 12TH ROAD CENTERLINE.

ELEV.: 806.206 NGVD 29

ELEV.: 805.734 NAVD 88

TBM-LL1

TOP OF 10 INCH SQUARE CONCRETE POST, APPROXIMATELY 220 FEET EAST ALONG LAWRENCE LAKE DRIVE FROM INTERSECTION WITH OLIVE TRAIL, 4.2 FEET ABOVE GRADE, 33 FEET NORTHEAST OF A CURVE TO THE SOUTH.

ELEV.: 788.79 NGVD 29

TBM-LL2

RAILROAD SPIKE IN NORTH SIDE OF UTILITY POLE #14342, APPROXIMATELY 0.2 MILE SOUTHEAST ALONG LAWRENCE LAKE DRIVE FROM INTERSECTION WITH OLIVE TRAIL, AT NORTHWEST CORNER OF 14337 LAWRENCE LAKE DRIVE, 20' SOUTH OF THE CENTERLINE OF THE ROAD.

ELEV.: 781.77 NGVD 29

TBM-LL3

RAILROAD SPIKE IN NORTHEAST SIDE OF UTILITY POLE #14172, APPROXIMATELY 0.4 MILE SOUTHEAST ALONG LAWRENCE LAKE DRIVE FROM INTERSECTION WITH OLIVE TRAIL, AT NORTHWESTERLY CORNER OF 14169 LAWRENCE LAKE DRIVE, 22' SOUTHWEST OF THE CENTERLINE OF THE ROAD.

ELEV.: 794.87 NGVD 29

TBM-LL4

TOP OF NORTH END OF RAILROAD RAIL POST, APPROXIMATELY 0.7 MILE SOUTHEAST ALONG LAWRENCE LAKE DRIVE FROM INTERSECTION WITH OLIVE TRAIL, AT SOUTHEAST CORNER OF 14043 LAWRENCE LAKE DRIVE, 4.0 FEET ABOVE GRADE, APPROXIMATELY 140 FEET SOUTHEAST OF A CURVE TO THE NORTH.

ELEV.: 831.53 NGVD 29

TBM-LL5

RAILROAD SPIKE IN NORTHEAST SIDE OF UTILITY POLE, AT NORTHEAST CORNER OF NATAKA TRAIL AND OLIVE TRAIL INTERSECTION, 50 FEET EAST OF OLIVE TRAIL CENTERLINE, 23 FEET NORTH OF NATAKA TRAIL CENTERLINE.

ELEV.: 811.94 NGVD 29

TBM-LL6

TOP OF RAILROAD RAIL POST, APPROXIMATELY 0.15 MILE NORTH ALONG NATAKA TRAIL FROM INTERSECTION WITH 13TH ROAD, AT SOUTHWEST CORNER OF INTERSECTION WITH A DEAD END ROAD TO THE NORTH, 4.2 FEET ABOVE GRADE, POST IS 20 FEET NORTHWEST OF ANOTHER RAILROAD RAIL POST, 20 FEET SOUTH OF NATAKA TRAIL CENTERLINE, 40 FEET WEST OF DEAD END ROAD CENTERLINE.

ELEV.: 818.18 NGVD 29